

PB13

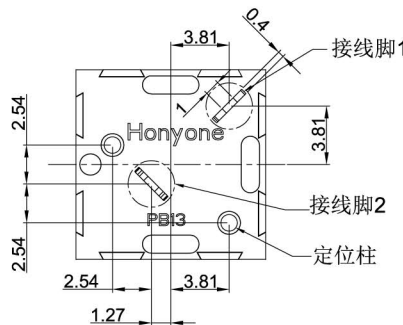
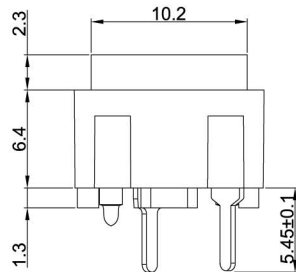
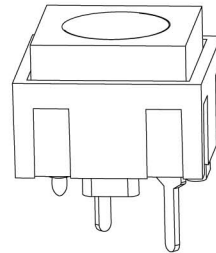
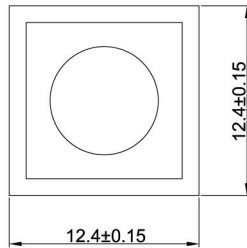

SPECIFICATIONS:

Circuit: SPST

Current:rating: 0.5A 30VDC ;
0.25A 50VDC ;

Contact resistance: 50m Max. (Initial) ;

Insulation resistance: 100MΩ Min. ;

Insulation strength: 1000VAC for 1 minute ;

Operating force: 300±100gf ;
400±100gf ;

Total travel: 1.0±0.25mm ;

Electrical Life: 100,000 cycles Min. ;

Machine Life: 200,000 cycles Min. ;

Manual welding: 350°C for 3 seconds;

Operating temperature: -25°C~+70°C ;

Surroundings humidity: 85%RH Max. ;

Function: Momentary

MATERIAL:

Frame:PA66+GF,UL rated:94V-2 Min. ;

Cap:ABS ;

Terminal:Brass,Silver plated ;

Dome: SST, Silver plated with single side.

Note:

1.This product is strictly prohibited wave soldering and reflow soldering,please use the manual welding processing, temperature of 350°±5°and time is 3±0.5 seconds;

2.After the product is welded on the PCB board,it is prohibited to use any solvent to clean the PCB board,and avoid the influence of the inner product.

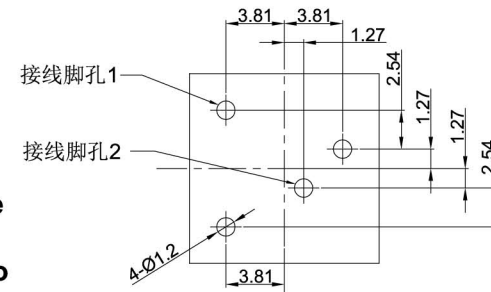

P.C.B.LAYOUT

PB13-A-BN-S
01.087.0091